

# WSYOs | WSCO 2020-2021 COVID-19 Season Plan

## I. Introduction

As we look forward to next season and how we can continue to provide an ensemble experience; the safety of participants, parents, and staff is paramount. Every decision made will be adhere to the best advice from federal, provincial, and city guidelines and mandates. We have been diligently working to adapt our ensembles to meet the need of our community while ensuring we provide the safest environment to do so.

## II. Season Structure

### A. Season Breakdown

1. We will divide the WSYOs | WSCO season into three 8-week movable seasons: Fall, Winter, Spring. Each of these “seasons” will allow us to respond and adhere to the most current health and safety regulations.
2. Fall Season: September 18<sup>th</sup> – November 14<sup>th</sup>  
Winter Season: January 17<sup>th</sup> – March 7<sup>th</sup> [delivered digitally]  
Spring Season: March 26<sup>th</sup> – May 16<sup>th</sup>

### B. Examples:

1. In February, if health officials determine that we will be safe to return to normal activities, we will end the Winter Season early, and return to more normal ensemble structures for the Spring Season.
2. In February, if health officials move us to phase 2 (under 50 people allowed to gather), we will then extend our Winter Season and shift our Spring Season to late May into early June.

Note: We will not extend the Spring Season past the school year.

### C. Winter Season:

1. As of now, all current projections of a second wave of COVID-19 coincide with the peak of flu season in early February. With this in mind, we will plan on delivering the Winter Season digitally.

2. This Winter Season will focus on other fundamental musicianship skills that we normally do not have time to address. Topics will include: Music Theory/Aural Skills Modules, Music History Modules, Digital Masterclasses, Digital Recitals, as well as Guest Speakers.

### **III. Ensemble Structures**

In order to provide an experience for the most amount of people while keeping health and safety paramount, we must reorganize the make-up of each ensemble. In order to adhere to social distancing guidelines, each ensemble will be capped at 36 musicians.

#### **A. Ensemble Composition:**

1. WSJYO
  - a) This ensemble will remain the same. (WSJYO typically has around 20 - 30 musicians).
2. WSYO String Orchestra
3. WSCO String Orchestra
4. WSYO/WSCO Wind Ensemble

#### **B. String Orchestra Threshold**

1. In order to minimize the number of days the Joy Theatre will be utilized; we will combine the WSYO and WSCO string orchestras if there are 36 (or fewer) total string players interested in participating. This singular string orchestra would meet on Sundays.

### **IV. Rehearsal Days and Times**

#### **A. Rehearsal Schedule**

##### **FRIDAY**

WSCO String Orchestra: 7:00 – 8:30 PM

**SUNDAY** (30-minute breaks between ensembles for ventilation and cleaning)

WSJYO: 12:00 – 1:15 PM

WSYO String Orchestra: 1:45 – 3:15 PM

WSYO/WSCO Wind Ensemble: 3:45 – 5:15 PM

## **B. Reasons for Change**

1. Changes to rehearsal days and times are designed to accommodate the following factors:
  - a) The WSO's altered COVID-19 recording schedule.
  - b) The majority of these recordings occur during "normal" rehearsal times.
  - c) These recordings now require Associate Conductor to assist with back end artistic leadership such as camera angles and timing of shots.
  - d) Each recording session requires use of the Joy Theatre Tech booth during and after recordings.
  - e) Limit the number of people in the building at the same time.
  - f) Allow for proper sanitation of rehearsal spaces and common areas.

## **V. Performances**

All performances will be pre-recorded in the Pentastar Theatre and aired a week after the recording date. Access to these digital performances will be free and available to share with friends and family.

### **A. Recording and Airing Dates**

1. Performance recordings will happen on the following days
  - a) Sunday November 14<sup>th</sup>
  - b) Sunday May 16<sup>th</sup>
  - c) WSCO String Orchestra, will need to record on Sunday and not Friday due to camera crew.
2. Performance recordings will be aired on the following dates:
  - a) Sunday, November 21<sup>st</sup> (Time TBD)
  - b) Sunday, May 23<sup>rd</sup> (Time TBD)
  - c) Performances will likely be password protected. We will distribute said password to all members.

## **VI. Sanitation Norms and Procedures**

### **A. Masks**

1. We will require all students, parents, participants, and staff to wear masks while in the building.

2. Wind Players will be allowed to remove their masks ONLY when they are in their seats playing. You will be required to put your mask on when you pack up and leave.

**B. Traffic Flow**

1. In order to avoid people having to pass one another in a tight corridor, we will be implementing a one-way traffic pattern through the building.
  - a) Student Entrance: Through the side door off Pelissier St. into the Joy Theatre.
  - b) Students will not be let in the Joy until the previous ensemble has left.
  - c) Parents who wish to wait at the Capitol, can enter through the RIGHT set of wooden doors off University Ave. ALL Parents and students will EXIT through the LEFT set of wooden doors off University.
  - d) All doors will be clearly marked. Entrance and exit through the wooden doors off University Ave. will be divided by stanchions.
  - e) For safety and security, once rehearsal starts, the side entrance door will be closed and locked. **If you are late to rehearsal, you will have to enter through the front lobby doors and escorted to the Joy Theatre.**

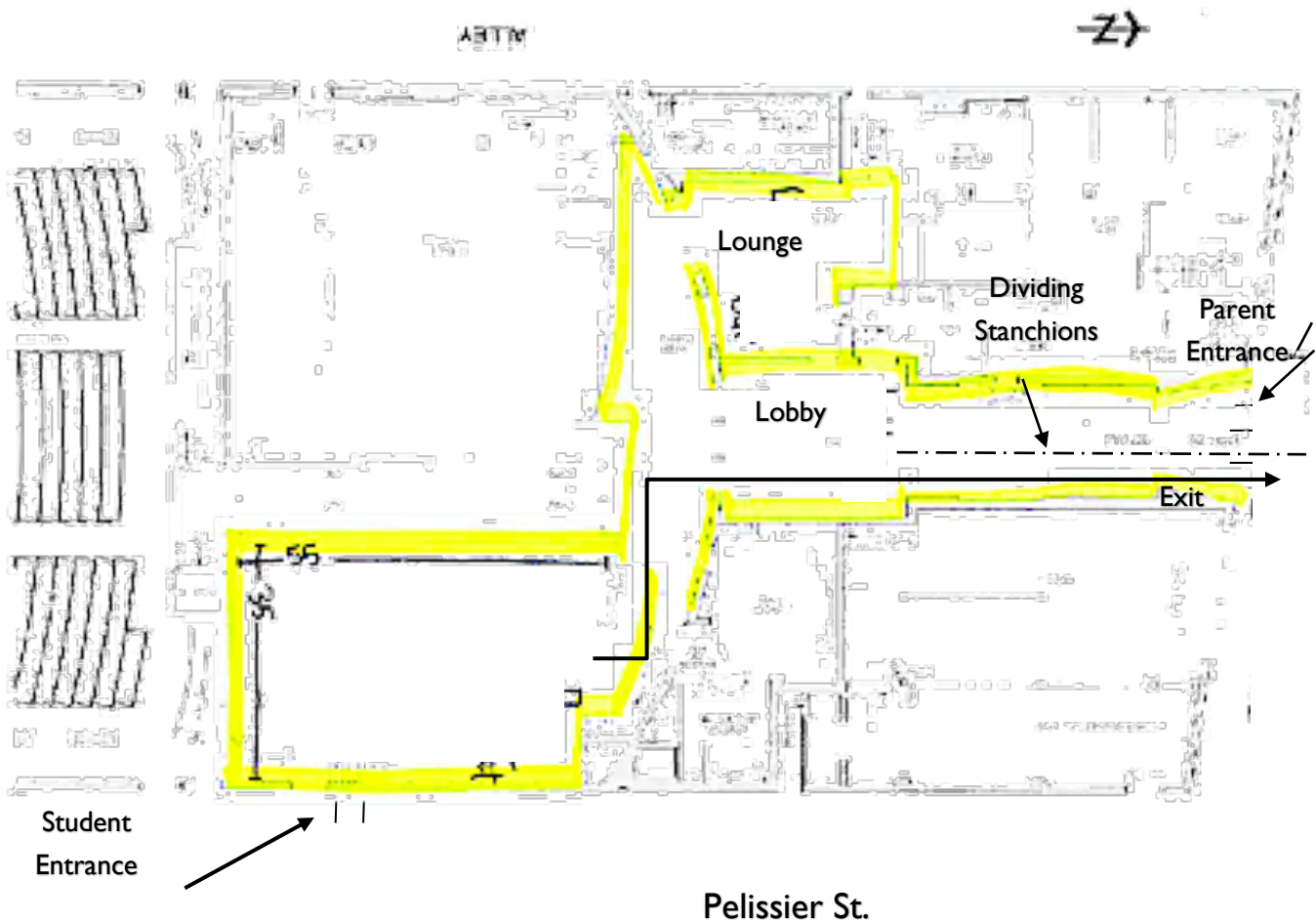

### C. Other Sanitation Procedures:

1. All participants will be required to bring their own stands and pencils.
2. Cases will need to be stored under or near your chair. Larger instruments will place cases in pre-designated areas.
3. To help reduce aerosol accumulation, wind players will be required to purchase a covering / shields for their bell or instrument.
  - a) [DIY Flute Shields](#)
  - b) [Woodwind Instrument Coverings](#)
  - c) [Brass Instrument Coverings](#)
4. Where needed we will provide extra protection via plexiglass or dividing curtains to minimize potential contact with aerosols.
5. Flute players will be stacked vertically along the left side of the ensemble to ensure their instrument is not facing anyone.
6. Brass players will be required to bring an extra cloth to empty spit valves and ensure excess condensation does not end up on the floor.
7. To ensure maximum airflow, we will continually work with the city to ensure our HVAC systems are regularly checked and maintained.
8. Percussionists will be required to bring their own mallets and will need to assist in any extra sanitation procedures of instruments used.
9. Each participant will be asked to wipe/spray down the chair that they used for the next person (we will provide sanitary equipment to do so safely).
10. Washroom usage will be limited to emergencies.
11. We will provide hand sanitizer stations in the Joy Theatre and Lobby area.
12. The lobby and café area will be set up to accommodate social distancing measures.

## VII. Ensemble Fees

All ensemble fees will be kept the same respective to your “home” ensemble (WSJYO, WSYO, WSCO). This includes all sibling discounts for WSYOs.

### A. Payment Options

1. In order to ensure maximum flexibility, we will be asking members to pay tuition in thirds. One third for each partial season (fall, winter, spring). This will allow all of us to respond more effectively to a rapidly changing health environment.
2. For convenience, members will also have the option to pay for the full season as we have done before. Please note, this option will not be eligible

for a refund. If you wish to withdraw, the remainder of your season fee will be considered a donation, and you will be issued a pro-rated tax-deductible receipt.

**B. SoCA Students**

1. All SoCA students who participate in the WSYO or WSCO, will retain fees schedules as outlined in our MoU with SoCA.
2. SoCA students will also be asked to pay in thirds.

**C. Payment Schedule & Late Fees**

1. Payment Schedule:
  - a) Fall Season: October 4<sup>th</sup>
  - b) Winter Season: January 24<sup>th</sup>
  - c) Spring Season: April 4<sup>th</sup>
2. Keeping with precedent from previous seasons, payments will be due a week after the first rehearsal/session has met. After this time, a late fee of \$20 will be assessed unless staff is notified of the need for additional time to pay.

**D. Methods of Payment**

1. In order to minimize the handling of tender such as cheques and cash, we will be asking participants to pay online. Each participant will receive an email invoice via Square approximately 2-weeks prior to the first session.
2. If you are unable to pay online, please contact us, and we will set up an alternative method of payment.